

Thomas Jefferson moved here from nearby Shadwell, his family plantation, soon after this free-standing dwelling was erected in 1770. The first brick structure

SOUTH PAVILION

built at Monticello,

it contained one room over a kitchen. For most of its history Jefferson called it the “outchamber.” On January 1, 1772, he married 24-year-old widow Martha Wayles Skelton (1748–82), the daughter of a wealthy tidewater Virginia planter. They lived here with at least one child until the main house was habitable, about 1774. After the completion of the flanking North Pavilion in 1808, the outchamber was usually called the South Pavilion.

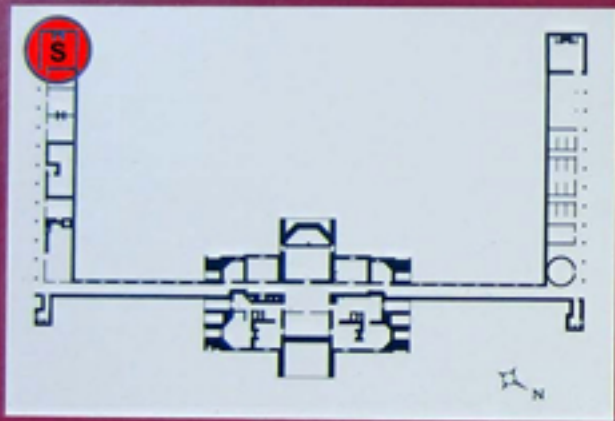

Plan of the cellars and dependencies, ca. 1809.